

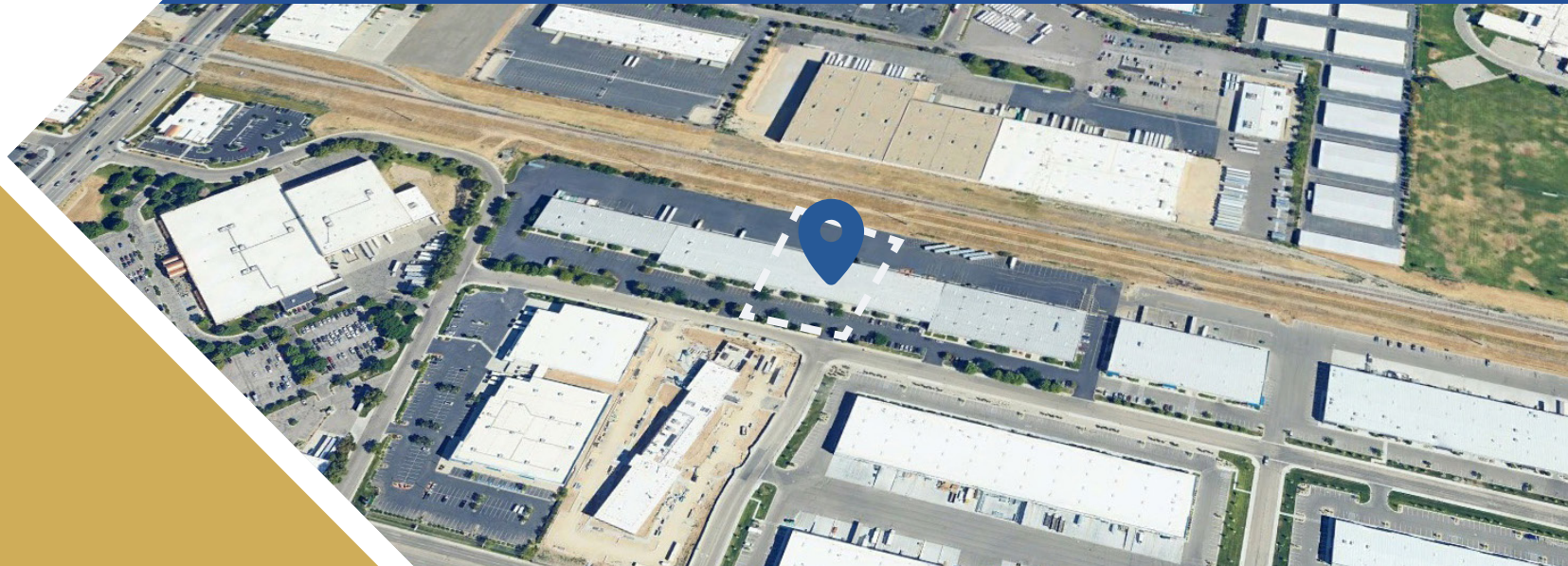

22,740 SF Industrial Space AI Meridian Industrial Park

EAST LANARK ST. | MERIDIAN, IDAHO



Property Highlights

- 22,740 SF Available for Lease
- Available Now
- Easily Accessible to the I-84, just 1 mile to the property and 20 minutes to the Boise Airport.



Contact

Charity Nelson – Director of Leasing
cnelson@adler-industrial.com

adler-industrial.com

 (+1) 208-506-7170

 8665 W. Emerald Street, Suite 200,
Boise, ID 83704, USA



22,740 Total SF Industrial Space

AI Meridian Industrial Park

**EAST LANARK ST.
MERIDIAN, IDAHO**

22,740 SF

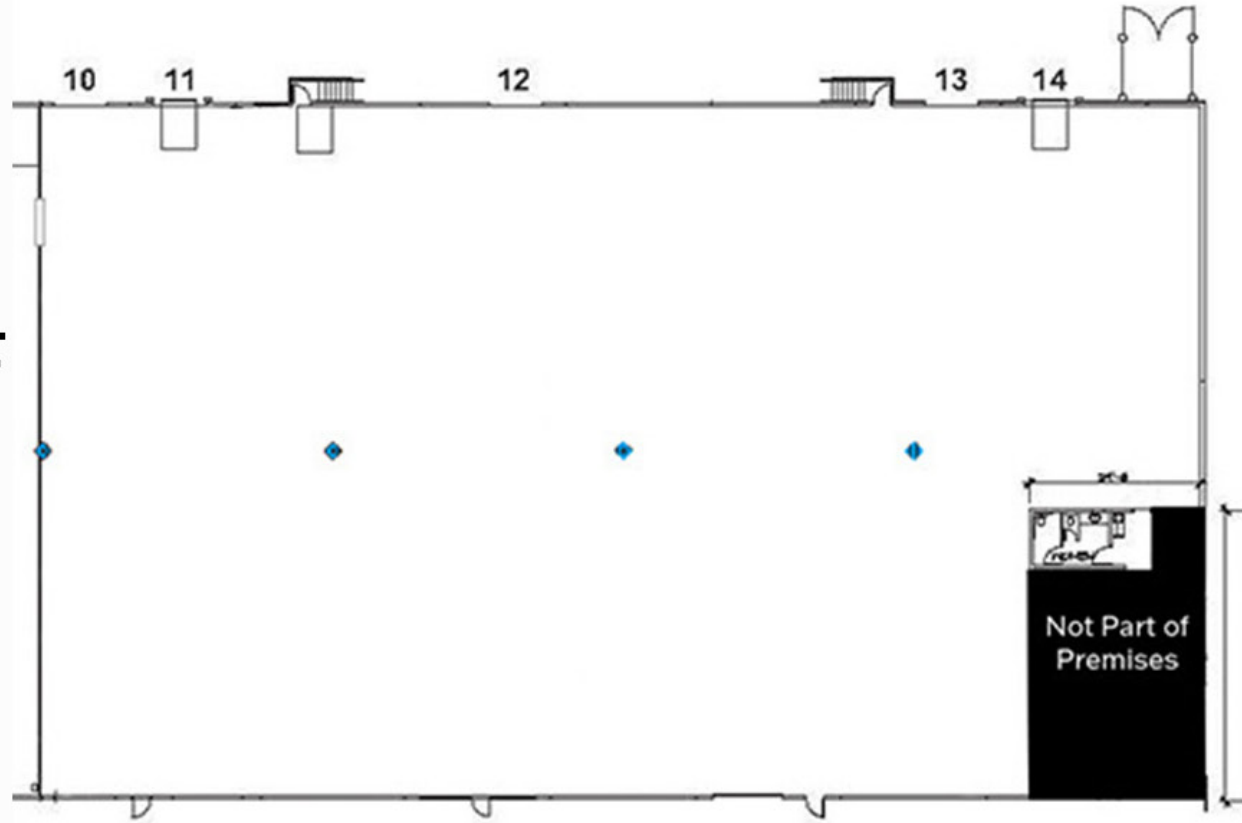

Building Plan

- **BUILDING SIZE:** 142,800 SF
- **AVAILABLE FOR LEASE:** 22,740 SF
- **BUILDING TYPE:** Industrial
- **CONSTRUCTION:** Concrete Tilt
- **YEAR BUILT:** 1996
- **FIRE SUPPRESSION:** ESFR Fire Sprinklers
- **LEASE TYPE:** NNN
- **CLEAR HEIGHT:** 24'
- **DOORS:** 5 dock high, 2 drive in
- **COLUMN SPACING:** 50'



22,740 SF Industrial Space

AI Meridian Industrial Park

**EAST LANARK ST.
MERIDIAN, IDAHO**



Access

Boise Airport	+/- 20 min / 19 miles
I-84 Interstate	+/- 2 min / 2 miles
Downtown Boise	+/- 20 min / 20 miles



Visit adler-industrial.com for more information

90+

PROPERTIES ACQUIRED OR
DEVELOPED IN BOISE MSA



The largest industrial real estate
development and management
company in Idaho

Adler Industrial specializes in vertically integrated solutions for Class “A” industrial development, including developing, constructing, leasing, investing, and property management. With over 4 million square feet of acquired or developed buildings and 1,000 acres of land for future projects, we lead the market in providing comprehensive industrial solutions. Our sister company, Adler Realty Investments, founded in 1996, has acquired or developed 5.9 million square feet of properties, across all asset types nationwide.



Contact

Charity Nelson – Director of Leasing
cnelson@adler-industrial.com

adler-industrial.com

 (+1) 208-506-7170

 8665 W. Emerald street, Suite 200,
Boise, ID 83704, USA